

Machickanee Horse Trails Outback Riders

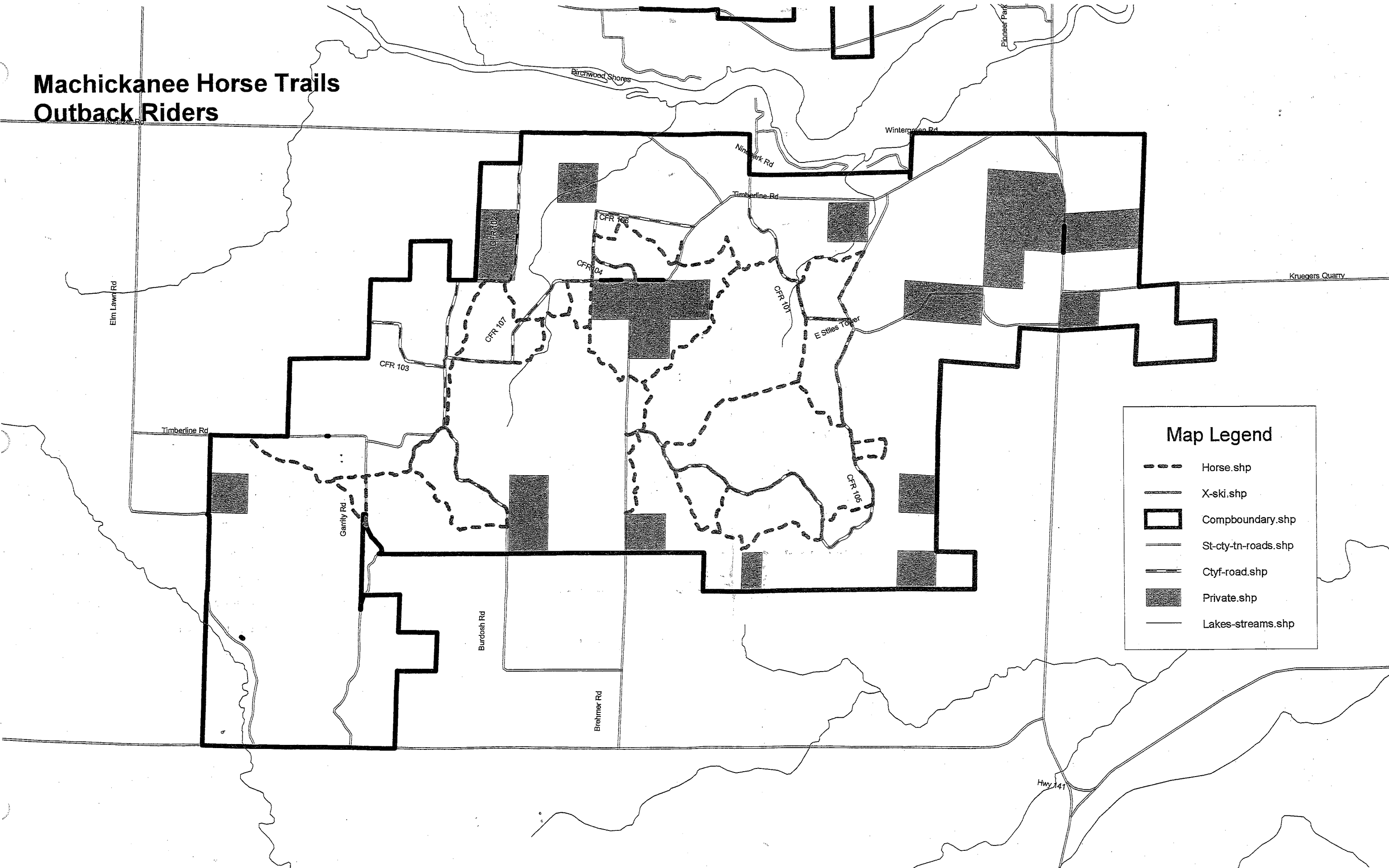

Map Legend

- Horse.shp
- X-ski.shp
- ▭ Compboundary.shp
- St-cty-tn-roads.shp
- Ctyf-road.shp
- Private.shp
- Lakes-streams.shp

Primitive Camping Permit Fee \$30.00

Oconto County Forest
301 Washington Street
Oconto, WI 54153
920-834-6995

Name: _____

Address: _____

Vehicle License/Make/Model: _____

Camping Unit: _____

Phone: _____

Camping permit valid

Start: _____

Ending: _____

Not to exceed 14 days

Circle Site Chosen

Campsite: Fire Tower CFR101 CFR 105

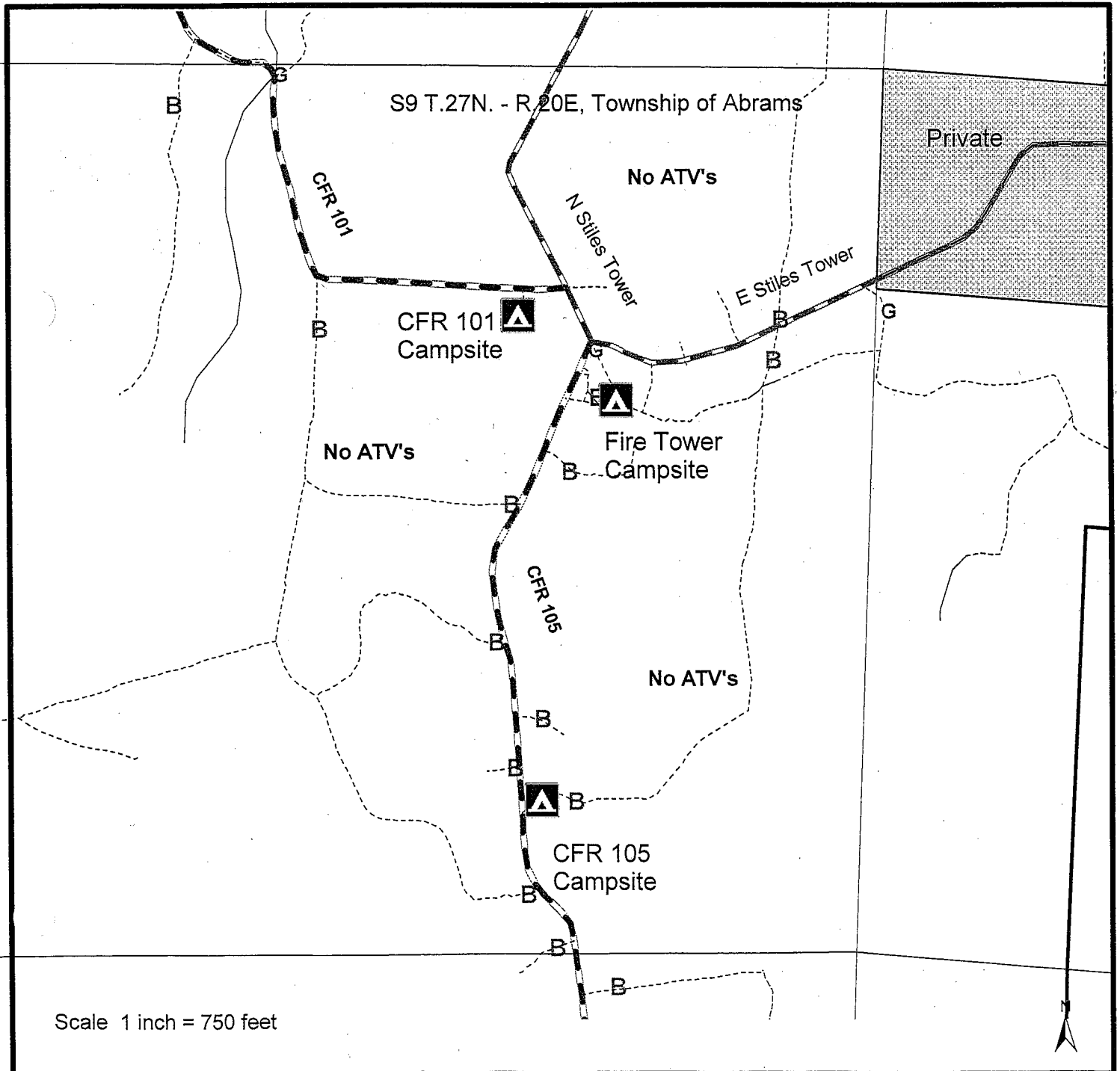

Primitive Camping Permit

Fee \$30.00

Oconto County Forest
301 Washington Street
Oconto, WI 54153
920-834-6995

Name: _____

Address: _____

Vehicle License/Make/Model: _____

Camping Unit: _____

Phone: _____

Camping permit valid

Start: _____

Ending: _____

Not to exceed 14 days

Circle Site Chosen

CFR 104 Campsite #1 #2 CFR 106 CFR 107

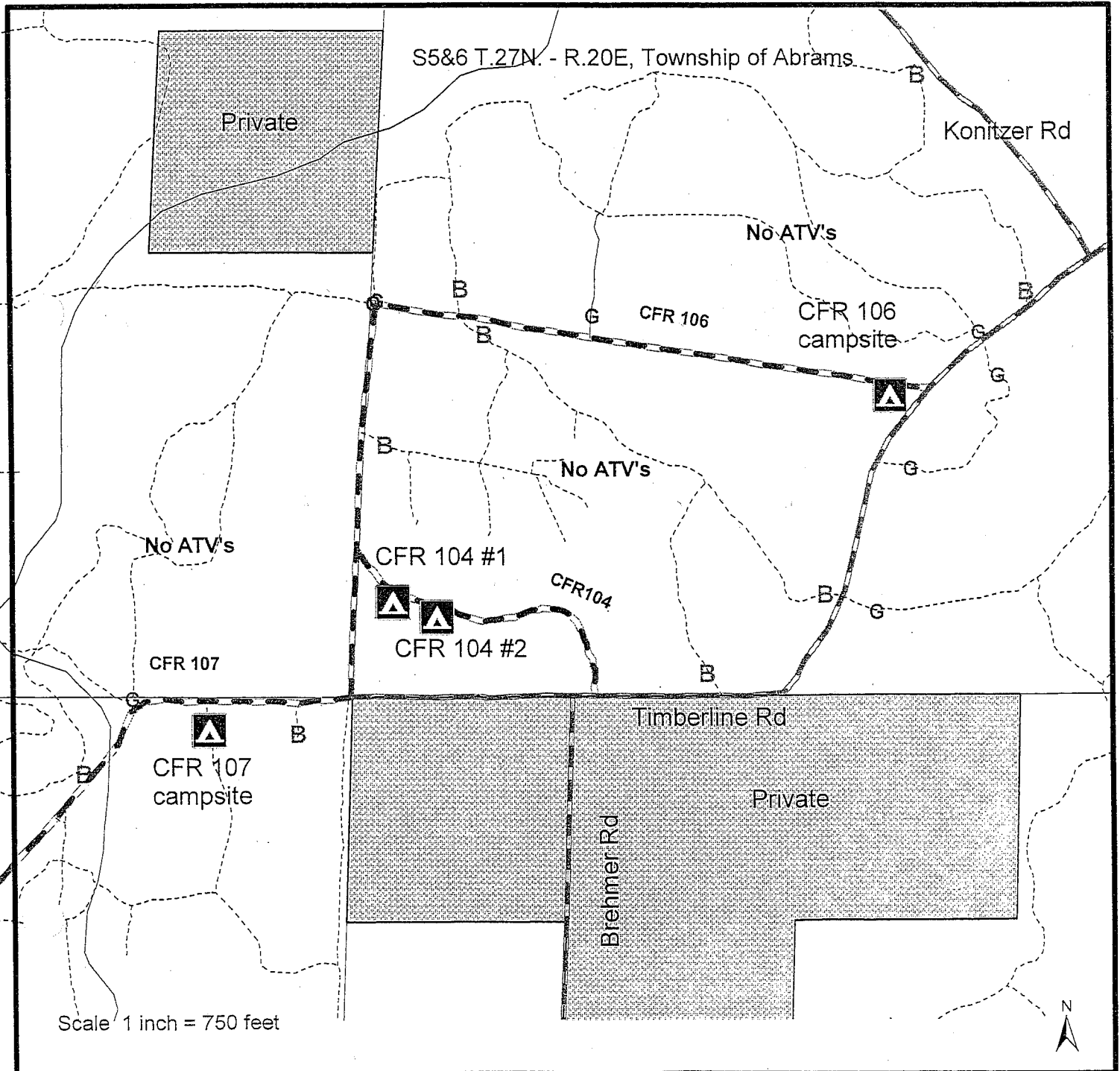

Primitive Camping Permit Fee \$30.00

Oconto County Forest
301 Washington Street
Oconto, WI 54153
920-834-6995

Name: _____

Address: _____

Vehicle License/Make/Model: _____

Camping Unit: _____

Phone: _____

Camping permit valid
Start: _____

Ending: _____

Not to exceed 14 days

Brehmer Rd

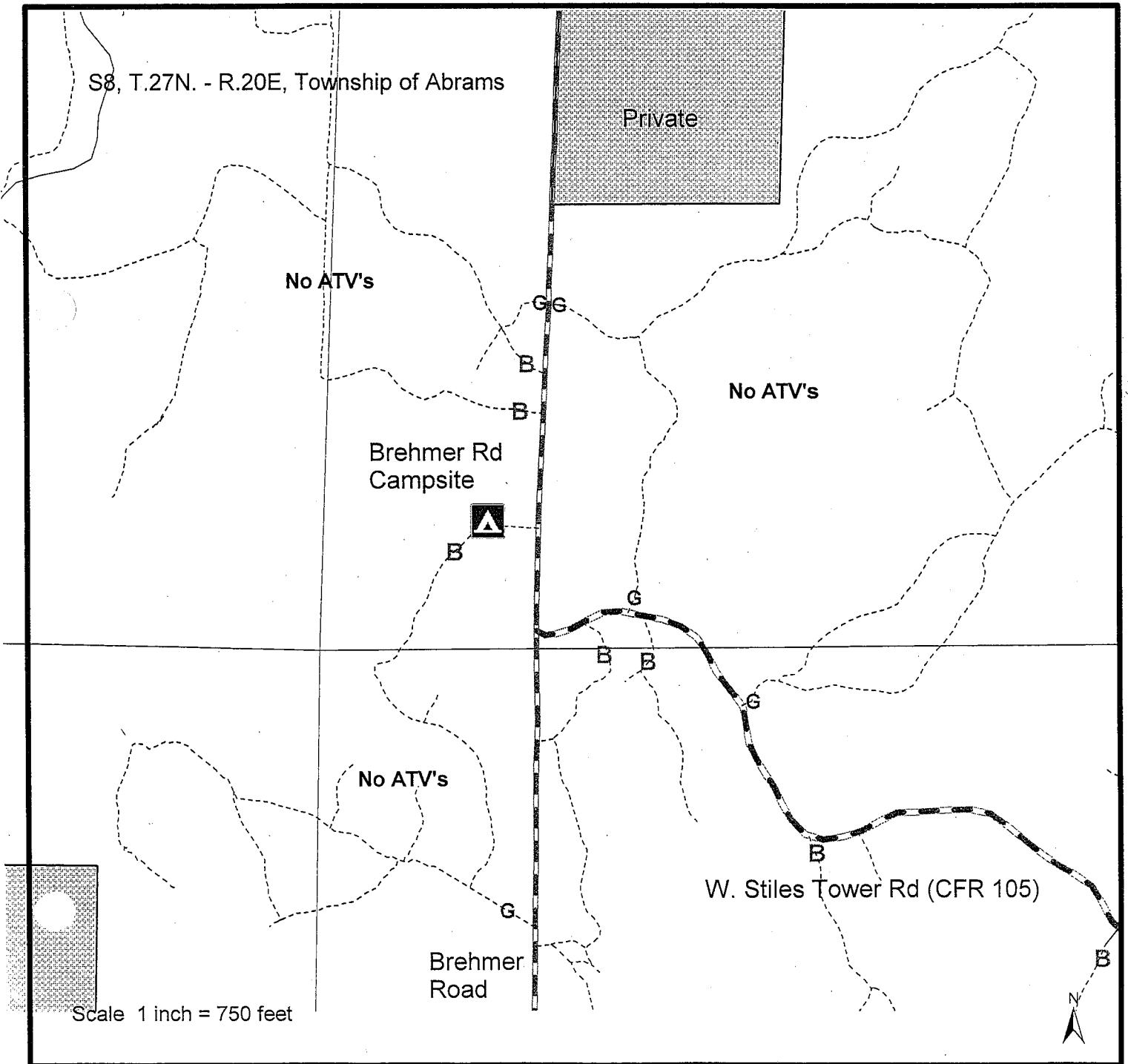

PRIMITIVE CAMPING PERMIT CONDITIONS

Permittee is subject to the following conditions:

1. This permit is authorized by the Forest, Parks, and Recreation Committee of the County Board of Supervisors, as provided in the Oconto County Forestry Ordinance.
2. Permittee shall follow the Oconto County Forestry/Parks Code of Ordinance Chapters 9 & 10.
3. Permittee shall carry camping permit at all times.
4. The permittee shall take all reasonable precaution to prevent and suppress fires, and must observe all fire regulations as set forth by the Wisconsin DNR.
5. The permittee must carry out all garbage and other litter and police their campsite so as to leave it in as natural condition as possible before vacating the campsite.
6. The permittee is permitted to utilize dead and down trees only for fuel wood. No living trees are to be cut.
7. This permit may be revoked at any time when the permittee or any member of his family or guest have been convicted of a violation of the state game laws or forest fire laws, or the regulations of this permit as herein provided. Furthermore, in the event of such conviction, no future permits will be issued to said permittee for a period of five (5) years.
8. This permit cannot be assigned, and is subject to all valid claims.
9. Gate must be locked after entering and leaving, if applicable. Combination _____.
10. Permittee responsible for damages to road. Rutting of road is prohibited.
11. By signing this permit, permittee agrees to the above and agree to hold heretofore. Permittee agrees to indemnify and hold harmless the County from all claims, damages, and expenses including attorney fees arising from this permit.
12. Firewood Restriction – Firewood from outside State of Wisconsin prohibited. Includes all wood meant for use in a campfire. Oconto County may seize and dispose of firewood in violation of restriction.

OCONTO COUNTY FORESTS, PARKS & RECREATION COMMITTEE

BY: _____
County Forest Administrator

DATE: _____

BY: _____

DATE: _____

Morgan

Abrams

